

# Expression of Interest for Transfer Station Supply, Installation and Commissioning RC/0169/003/0

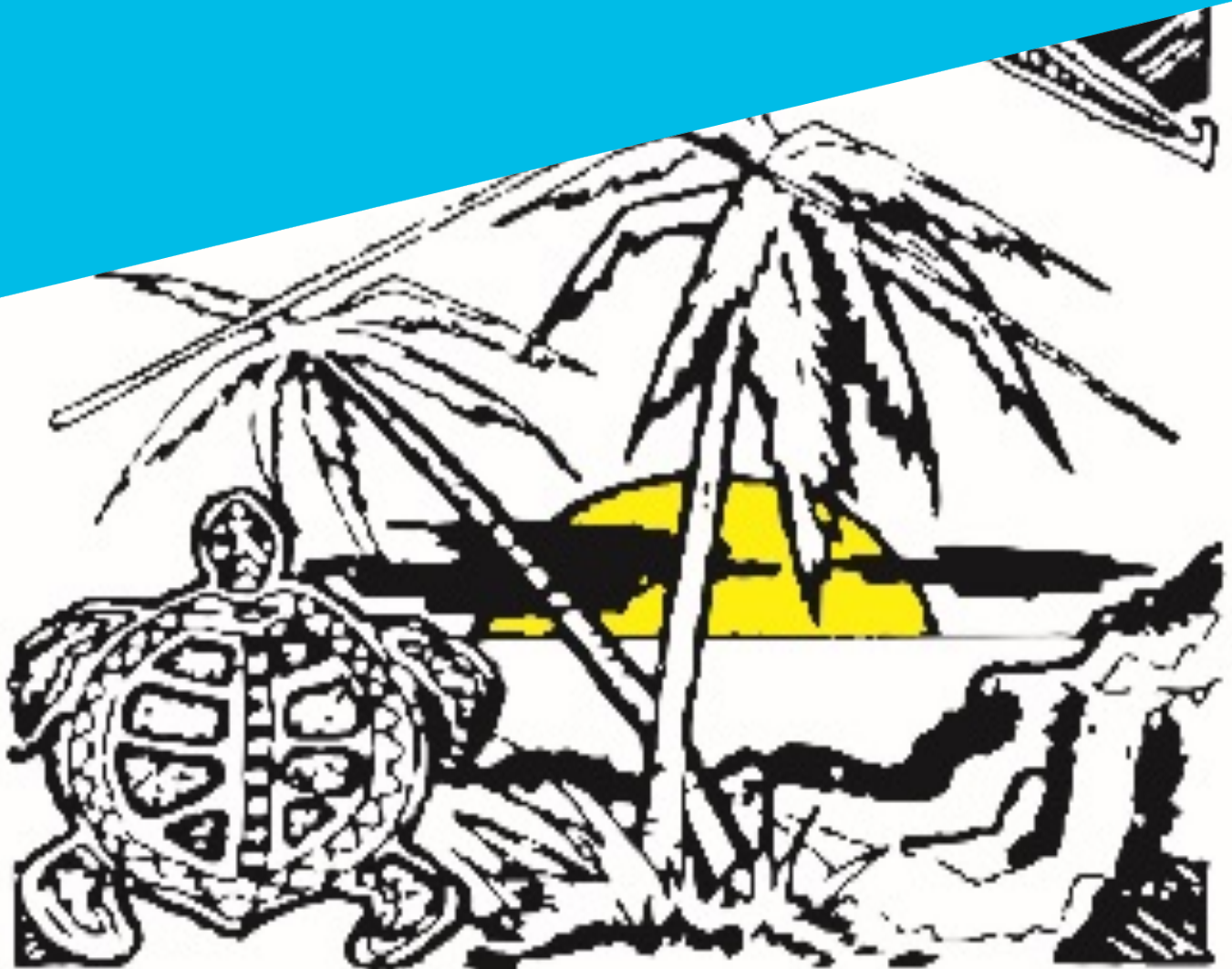

**WUJAL WUJAL**  
**ABORIGINAL SHIRE COUNCIL**

## Specification No.: 60327208 EOI 1

Client: Wujal Wujal Aboriginal Shire Council

ABN: N/A

Ref 60327208

Date 25-Jan-2018

Prepared by Bronwyn van Gool

Reviewed by James Jentz

### Revision History

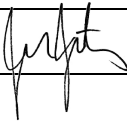
Rev	Revision Date	Details	Authorised	
			Name/Position	Signature
Draft	1-Dec-2017	Expression of Interest	James Jentz Associate Director	
Final	25-Jan-2018	Expression of Interest	James Jentz Associate Director	

#### AECOM Australia Pty Ltd

Level 3, 120 Bunda Street, PO Box 5971, Cairns QLD 4870, Australia  
T +61 7 4222 6000 F +61 7 4222 6001 www.aecom.com  
ABN 20 093 846 925

AECOM in Australia and New Zealand is certified to ISO9001, ISO14001 AS/NZS4801 and OHSAS18001.

© AECOM Australia Pty Ltd (AECOM). All rights reserved.

AECOM has prepared this document for the sole use of the Client and for a specific purpose, each as expressly stated in the document. No other party should rely on this document without the prior written consent of AECOM. AECOM undertakes no duty, nor accepts any responsibility, to any third party who may rely upon or use this document. This document has been prepared based on the Client's description of its requirements and AECOM's experience, having regard to assumptions that AECOM can reasonably be expected to make in accordance with sound professional principles. AECOM may also have relied upon information provided by the Client and other third parties to prepare this document, some of which may not have been verified. Subject to the above conditions, this document may be transmitted, reproduced or disseminated only in its entirety.

## Table of Contents

1.0	Background	1
2.0	Expressions of Interest	1
3.0	Tenders	2
4.0	Design and installation of the facility	2
4.1	Design	2
4.2	Transfer station and recycling facility functions and equipment	2
4.3	Other public accessible facilities functions and equipment	3
4.4	Council Depot / workshop functions and equipment	4
5.0	Commissioning and operator training	4
6.0	Required information	4
7.0	Evaluation criteria	4
Appendix A		
	Supporting Documents	A

## 1.0 Background

### Wujal Wujal Aboriginal Shire Council Transfer Station Upgrade

The Wujal Wujal community does not currently have a formal facility to dispose of domestic waste such as tyres, oil, batteries, whitegoods, etc. In order to provide a controlled facility for the disposal of domestic waste, Wujal Wujal Aboriginal Shire Council intends to install a waste transfer station and recycling facility at the existing Council works depot. This project will require modification of the infrastructure on the existing site to allow the Council depot and the transfer station to be located within the site. Modification of existing buildings and relocation of existing services within the Council depot may be required. The design will need to provide separation between the Council depot and the public access area. The existing workshop buildings are to be used to house the new facilities where suitable.

The facility will consist of the following elements:

- Transfer station and recycling facilities: dump bays, composter, glass crusher, material shredder, baling machine, bale store, recycling shop, used oil store (existing), public safe access point and a management facility for receiving waste.
- Council depot facilities: workshop, dog pound (existing), storage (existing), machine shed, employee carpark (existing), toilet block (existing), workshop admin (existing), weld shed and an employee entry.
- Other facilities with public access: service station (existing), wash down bay and a gas cylinder exchange (existing).

The attached drawings 170401-9, 170401-10 and 170401-11 show the site and a potential layout for the Council works, transfer station and recycling facility.

### Council Project requirements

Council regard the following as highly desirable for all projects:

- high life low ongoing cost cycle assets and items (including software)
- reduce/minimise the presence of toxic and hazardous materials
- conserve energy and water
- minimise the generation of waste and release of pollutants
- decrease greenhouse gas emissions
- improve environmental and public health
- provide ongoing real world opportunities for community education and employment.

## 2.0 Expressions of Interest

Expressions of Interest are sought for the supply, installation and commissioning of the Wujal Wujal transfer station and recycling facility and the associated upgrade works to the Council workshop.

The scope of works will include:

- design
- supply
- installation
- commissioning
- provision of operator training.

These works are to be complete in 2018.

**Expressions of Interest are to be lodged with AECOM via electronic copy at [cairns.tenders@aecom.com](mailto:cairns.tenders@aecom.com), OR by depositing a bound copy in the Tender Box at AECOM Australia. Level 3, 120 Bunda Street, Cairns by 5pm on 27 February 2018.**

### 3.0 Tenders

Following the assessment of the Expressions of Interest it is intended that two suitable firms will be short listed. Representatives for these two firms will be required to attend an onsite briefing prior to submitting a tender.

## 4.0 Design and installation of the facility

### 4.1 Design

During the design phase of the project, the contractor will assess and present suitable options and layouts for the facility to Council. The design should include the following elements:

- Waste transfer station and recycling facility and public accessible area:
  - Inclusion in the design of all functions and equipment as identified in sections 4.2 and 4.3.
  - Consolidation of Council waste to a central location, separate from the Council workshop facilities.
  - Modification of the existing workshop buildings to use for the transfer station and recycling facility where suitable.
  - Provision of new buildings where required.
  - Provision of safe public access to the facility.
  - Provision of an alternative rear access to the facility.
- Council Depot:
  - Preservation or enhancement of workshop functions as identified on site.
  - Modification of the existing workshop buildings as required.
  - Provision of new buildings where required.
  - Access for Council trucks to the workshop areas.
  - Perimeter fencing.
- General:
  - Identification of relevant authorities and/or licencing documentation.
  - Obtaining any regulatory approvals relating to construction and ongoing operational compliance.
  - Bitumen or concrete surfaces for the facility.
  - Water supply, sewerage, stormwater, electricity and communication services, including any upgrades required to these services to accommodate the facility.
  - Bunding, etc. required for spill provision.

### 4.2 Transfer station and recycling facility functions and equipment

The transfer station and recycling facility will include the following functions and equipment:

- Infrastructure and equipment for management of waste receivals.
- Public accessible collection bays as required to collect a variety of materials i.e.: glass, steels, plastic, cardboard, putrescibles/green waste.
- Glass pulveriser:

- Capable of processing all types of glass, up to 200 mm diameter.
- Able to produce pulverised glass 10 mm and smaller with rounded edges.
- Able to separate glass sand from debris (e.g. caps, corks and labels).
- Able to be used with both manual and conveyor infeed.
- Throughput of up to 200 to 450 kg/hour.
- Small footprint.
- Simple to operate.
- Low maintenance.
- Quiet operation.
- Tyre debader:
  - Capable of retrieving the steel wires around the tyre bead of auto light truck tyres up to 18 inch.
- Waste shredder twin shaft hydraulic drive capable of shredding light metals, drums, plastics cardboard, light automotive tyres, pallets and green waste:
  - Suitable for heavy duty applications.
  - Suitable for processing multiple products including light metals, drums, plastics, cardboard, light automotive tyres and green waste.
  - 810 mm by 730 mm minimum size cutting chamber.
- Vertical baler / binder:
  - Suitable for heavy duty applications.
  - Capable of producing mill sized bales, with weight of 450 kg.
  - Capable of baling a variety of waste products including plastic bottles, textiles and heavy duty materials.
  - Simple to operate – e.g. easy loading of waste and removal of bales.
  - Short cycle time.
  - Low maintenance.
  - Low operating costs.
- Covered storage area with the capacity to store 100 bales of mixed product (mill sized bales).
- Putrescibles green waste composter capable of 4.5 tonne monthly capacity.
- Bins and storage equipment as required by design.
- Recycle shop.

#### **4.3 Other public accessible facilities functions and equipment**

The other public accessible facilities will include the following functions and equipment:

- Public accessible pay per use truck wash station.
- Public accessible used oils facility capable of accepting maximum 200 L per day.
- The service station may be modified to allow the addition of management facilities for the waste receivals, however the existing functions of the service station must be preserved.

#### 4.4 Council Depot / workshop functions and equipment

The Council workshop functions currently on site need to be maintained with the addition of the transfer station and recycling facility. The existing functions which need to be available in the final design include:

- workshop
- dog pound
- storage
- machine shed
- employee carpark
- toilet block
- workshop administration building
- weld shed
- employee entry.

#### 5.0 Commissioning and operator training

The contract will require the transfer station and recycling facility to be commissioned such that it demonstrates compliance with all relevant regulations and licenses.

Training of the operators in the use of the transfer station and recycling facility equipment shall also be a requirement of the contract.

#### 6.0 Required information

Suppliers are invited to submit any information they wish to support their offer. However, they should ensure they supply sufficient technical information to permit a technical assessment of the suitability of their proposed processes and equipment.

As a minimum, the following information should be provided:

- Similar installations successfully undertaken.
- Referees for installations.
- Photographs of existing installations of similar size.
- Details of the proposed transfer station and recycling facility equipment, including make and model of all items.
- Budget price to design, supply, install and commission the facility.
- Details on operator training, including previous experience.
- Details of Quality Assurance status.

#### 7.0 Evaluation criteria

The Expressions of Interest will be evaluated against the following criteria:

- information provided in response to section 6.0 above
- understanding scope of works
- previous use in Australia and in remote areas
- capital cost
- operator training capability.

# Appendix A

## Supporting Documents



11  
-

LAND PARCEL PLAN

1:500

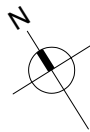

0 5 10 15 20 25  
SCALE 1:500 METRES

A	26/06/17	Issued For Review			LM TC
Rev.	Date	Amendments			Dr Ch



**Wujal Wujal Aboriginal  
Shire Council**  
Lot11/ Hartwig St, Wujal Wujal QLD 4895  
Contact: 0740 839 100 Fax: 0740 608 250  
Email: enquiries@wujalwujalcouncil.qld.gov.au

Do not scale drawing - all dimensions to be verified on site - if discrepancies occur, confirm dimensions and levels on site with engineer before commencing work.

© Copyright - Wujal Wujal Aboriginal Shire Council

Project  
**Waste Transfer and Recycling Centre**  
Wujal Wujal Area, Queensland 4895

Drawing <b>Site Plan</b>			Drawn LM Engineer RG
Date: 12 April 2017 Scale: 1:500 @ A3	Job No. 170401	Dwg No. 11	Rev. <b>A</b>



LEGEND

- ① Service Station
- ② Recycling Shop
- ③ Dump Bays
- ④ Wash Down Bay
- ⑤ Gas Cylinder Exchange
- ⑥ Used Oil Store
- ⑦ Composter
- ⑧ Glass Crusher
- ⑨ Material Shredder
- ⑩ Bailing Machine
- ⑪ Bail Store
- ⑫ Dog Pound
- ⑬ Storage
- ⑭ Machine Shed
- ⑮ Employee Carpark
- ⑯ Toilet Block
- ⑰ Workshop Admin
- ⑱ Weld Shed
- ⑲ Existing Workshop

- Gravel Roadway
- Bitumen Surface
- Concrete

B	26/06/17	Legend Updated, Stormwater Drain added	LM	RG	
A	12/04/17	Issued For Review	LM	TC	
Rev.	Date	Amendments	Dr	Ch	



**Wujal Wujal Aboriginal Shire Council**

Lot11/ Hartwig St, Wujal Wujal QLD 4895  
Contact: 0740 839 100 Fax: 0740 608 250  
Email: enquiries@wujalwujalcouncil.qld.gov.au

Do not scale drawing - all dimensions to be verified on site - if discrepancies occur, confirm dimensions and levels on site with engineer before commencing work.

© Copyright - Wujal Wujal Aboriginal Shire Council

Project  
**Waste Transfer and Recycling Centre**  
Wujal Wujal Area, Queensland 4895

Drawing <b>Site Plan</b>	Drawn LM Engineer RG
Date: 12 April 2017 Scale: 1:500 @ A3	Job No. 170401 Dwg No. 10 Rev. B

10 SITE PLAN  
- 1:500

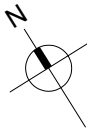

0 5 10 15 20 25  
SCALE 1:500 METRES

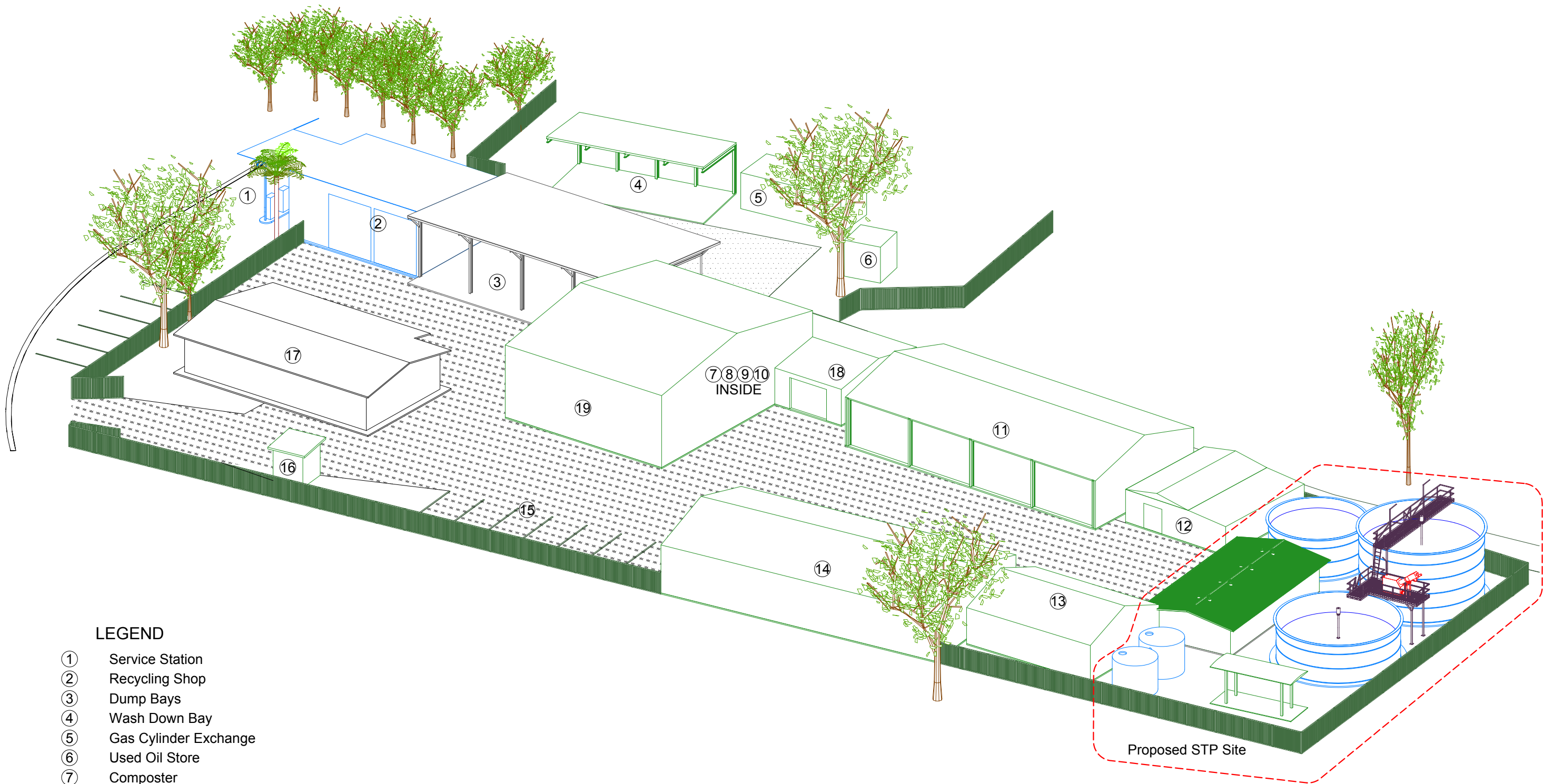
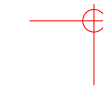

LEGEND

- ① Service Station
- ② Recycling Shop
- ③ Dump Bays
- ④ Wash Down Bay
- ⑤ Gas Cylinder Exchange
- ⑥ Used Oil Store
- ⑦ Composter
- ⑧ Glass Crusher
- ⑨ Material Shredder
- ⑩ Bailing Machine
- ⑪ Bail Store
- ⑫ Dog Pound
- ⑬ Storage
- ⑭ Machine Shed
- ⑮ Employee Carpark
- ⑯ Toilet Block
- ⑰ Workshop Admin
- ⑱ Weld Shed
- ⑲ Existing Workshop

02  
-

GENERAL ARRANGEMENT

Rev.	Date	Amendments	Dr	Ch
C	26/07/17	Legend Updated	LM	RG
B	29/03/17	Site Ammended	LM	TC
A	27/01/17	Issued For Review	LM	TC

Issued For Review



Wujal Wujal Aboriginal  
Shire Council

Lot11/ Hartwig St, Wujal Wujal QLD 4895  
Contact: 0740 839 100 Fax: 0740 608 250  
Email: enquiries@wujalwujalcouncil.qld.gov.au

Do not scale drawing - all dimensions to be verified on site - if discrepancies occur, confirm dimensions and levels on site with engineer before commencing work.

© Copyright - Wujal Wujal Aboriginal Shire Council

Project  
**Waste Transfer and Recycling Centre**  
Wujal Wujal Area, Queensland 4895

Drawing  
**General Arrangement**

Date: 25 Jan 2017  
Scale: NTS

Job No. 170401  
Dwg No. 09

Drawn LM  
Engineer RG  
Rev. C